



**RWL51**  
Radar level transmitter

- Contact level measurements for liquids and solids
- Max rod length 3 m  
rope / semi-flexible pipe 30 m
- Process pressure 40 bar
- 2/4 wires technology
- Pulse microwave TDR
- Display of alphanumeric level measurement and of the echo signal curve

RWL51 is a guided micro-wave sensor for liquids and bulk solids materials continuous measurement. Insensitive to environmental influences like dust and steam, RWL51 provides accurate and repetitive measurement values. RWL51 constitutes the solution for multiple level measurements. Suitable for application in silos or tanks, also in hard working conditions. Suitable for level measurement in tanks with 1 ½ “G or 2”g threaded. RWL51 is available with rope or rigid rod antenna..

**Technical Feature**

**Housing / Antenna material**

aluminum / SS316L / SS304

**Mechanical installation**

threaded G 1½”; G 2”

**IP rating**

IP67

**Electrical connection**

Terminals

**Working temperature**

-30° ÷ +130°C / -40° ÷ +150°C

**Pressure**

-1÷40 bar

**Power supply**

24Vdc; 230Vac

**Analog output**

4÷20mA

**Digital communication**

HART; MODBUS

**Measure range**

rod 3 m; rope 30 m; semi-flexible pipe 30 m

**Accuracy**

±10mm

**Resolution**

1mm.

**Calibraton**

4 buttons or via HART

**Warm up**

5 minutes

**Display**

Plug-in display/keyboard 4 buttons matrix LCD

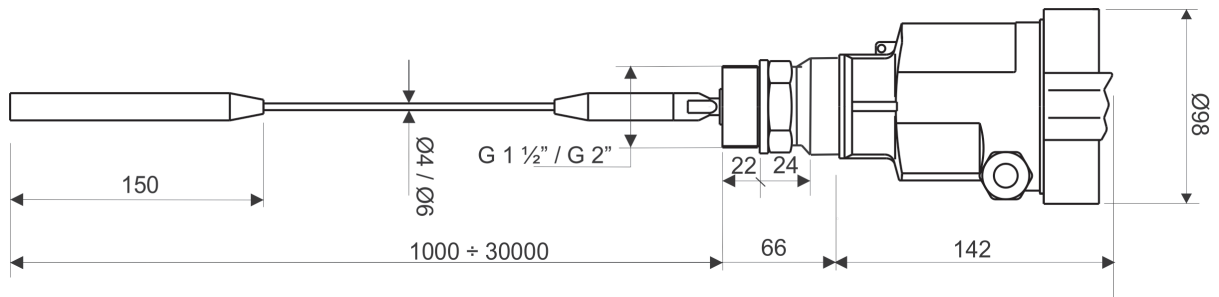

**RWL51** Guided microwave radar level transmitter  
 Microwaves pulse TDR  
 For liquids and bulk solids measurement  
 Max. length: rod 3m, rope and semi-flexible pipe 30m  
 Accuracy: ±10mm  
 Process pressure: -1+40 bar

Version	
<b>P</b>	Standard
Antenna shape / Material / Sealing	
<b>A</b>	Rope Ø 6mm / SS316L / PTFE
<b>B</b>	Rod Ø10mm / SS316L / PTFE
<b>C</b>	Semi-flexible pipe Ø8mm / SS304 / PTFE
Process connection / Material	
<b>GP</b>	Thread G1 1/2" / SS316L
<b>KP</b>	Thread G2" A / SS316L
<b>NP</b>	Thread 1 1/2" NPT / SS316L
<b>ZZ</b>	Special
Seal / Process temperature	
<b>A</b>	Viton / -30+130°C
<b>B</b>	Kalrez / -40+150°C
Electronic preamplifier	
<b>B</b>	4+20mA HART (2-wire); 24Vdc
<b>C</b>	4+20mA HART (4wire); 24Vdc
<b>D</b>	4+20mA HART (4wire); 230Vac
<b>R</b>	10+30 Vdc MODBUS RTU
Housing / Protection	
<b>D</b>	Aluminum 2 chambers (for 4-wire versions) / IP67
<b>G</b>	SS316L / IP67
<b>U</b>	Aluminum with transparent cap / IP67
<b>Z</b>	Special
Cable entry	
<b>M</b>	M20x1,5
Keyboard/display programming module VL602	
<b>A</b>	Yes
<b>X</b>	No
L= length, price each 100mm	
<b>A</b>	Rope Ø6mm / SS316L (max 30m)
<b>B</b>	Rod Ø10mm / SS316L (max 3m)
<b>C</b>	Semi-flexible pipe Ø8mm / SS304 (max 30m)